

WIRELESS LIMITSWITCH

APWT11RFH8

- Wirelessly connected to a relay unit, range up to 80m
- No batteries
- IP66



PRODUCT DESCRIPTION

SPECIFICATIONS

IP Class	IP66
Temperature range from	-25 °C
Temperature range to	70 °C
Material of body	Plastic

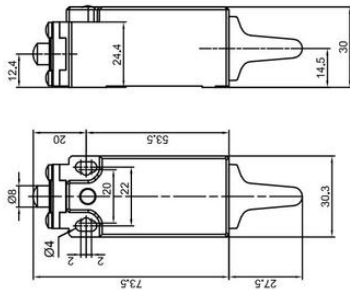

RRH8 (868MHz) and RRH9 (902MHz) receivers
Main features

Installation tips

The wireless signal works at its best when the space is free between the receiver and the transmitter.
Eliminate as far as possible obstacles, mostly if they are metallic!

● ZONE

Receiver	Transmitter
RRH8	RRH8
RRH9	RRH9

RRH8 (868MHz) and RRH9 (902MHz) receivers
Main features