

WIRELESS FOOTSWITCH

PSW11RFH8

- Wirelessly connected to a relay unit, range up to 80m
- No batteries
- IP66



PRODUCT DESCRIPTION

SPECIFICATIONS

IP Class	IP66
Temperature range from	-25 °C
Temperature range to	70 °C
Material of body	Plastic



Installation tips

The wireless signal works at its best when the space is free between the receiver and the transmitter. Eliminate as far as possible obstacles, mostly if they are metallic!

RRH8 (868MHz) and RRH9 (902MHz) receivers

Main features

Model	Frequency	Power	Range
RRH8	868 MHz	100 mW	80 m
RRH9	902 MHz	100 mW	80 m

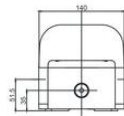
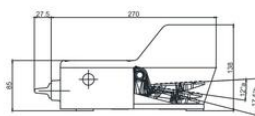
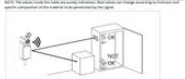

• coming